



KIRSOP CROSSING

Elm #1764 



Finishes on completed homes will vary from rendering

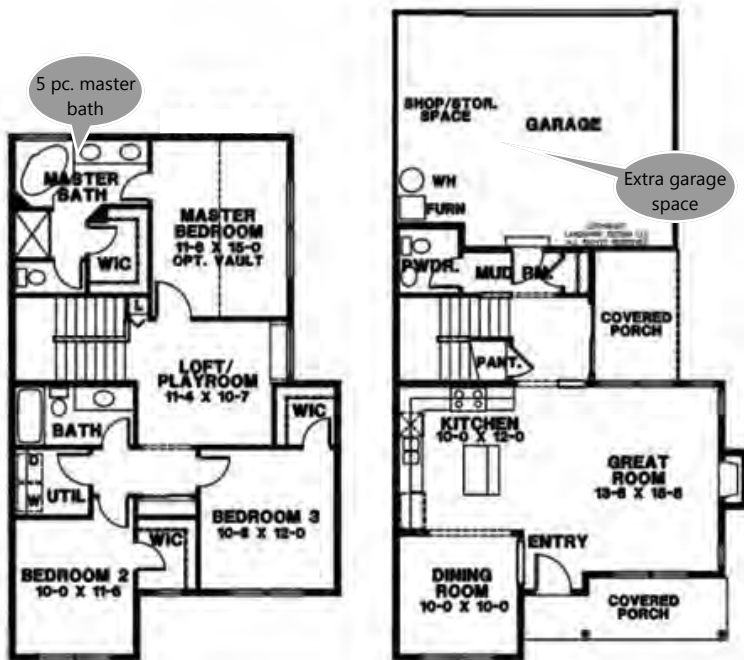

- 1764 square feet
- 3 Bedroom + Loft, 2.5 Bath
- Hardwood entry, kitchen, dining, great room
- Slab granite or quartz kitchen counters w/full tile backsplash
- Gas range with double oven
- Upper level loft
- Covered front & side porch
- Fully fenced & landscaped front & back



www.ColdwellBankerTeam.com

**ROB RICE
HOMES**
Creating Exceptional Communities Since 1985

Vonna Madeley
360.561.7888

Leslie Shipe
360.870.2530

Jeanne Tranum
360.481.2255



7/20/18



Builder reserves the right to change features, plans, prices and specifications without notice. Features vary by home. Buyer to verify square footage. Homes in the Kirsop Crossing Neighborhood are built, sold, and warranted by Evergreen Heights, LLC, a separate entity that is a member of the Rob Rice Homes family of companies.