



BRADBURY

BY ROB RICE HOMES

The
POPLAR #2692



ELEVATION A



ELEVATION C

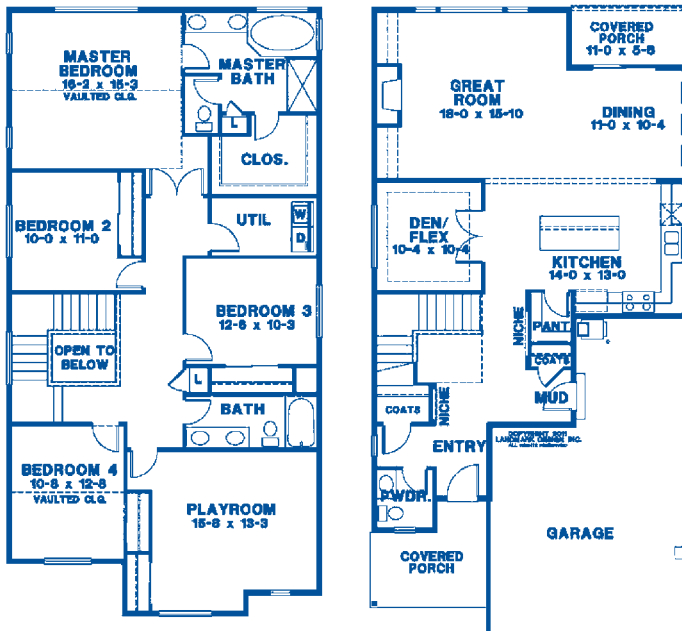

- 2,692 square feet
- 5 bedrooms, 2.5 baths
- 2-story plan
- Hardwood entry, kitchen and dining
- Slab granite or quartz kitchen counters with full tile backsplash
- 5-piece master bath
- 10 x 12 patio (as allowed by permitting)
- Fully landscaped with backyard fencing

ROB RICE
HOMES
Creating Exceptional Communities Since 1985

www.robricehomes.com
www.facebook.com/robricehomes



For more information contact: **HEATHER KEATING** | 425.442.5538 | heather@robricehomes.com  