



# KIRSOP CROSSING

## Hemlock #2136



Elevation A



Elevation B

*Finishes on completed homes will vary from rendering*

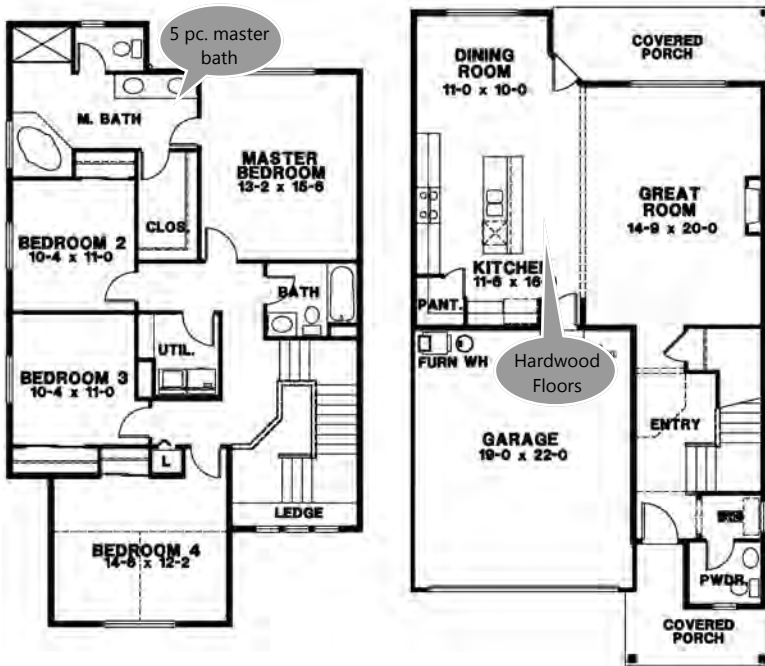

- 2136 square feet
- 4 Bedroom , 2.5 Bath
- Hardwood entry, kitchen, dining
- Slab granite or quartz kitchen counters w/full tile backsplash
- Gas range with double oven
- Main floor powder room
- Covered front & back porch
- Fully fenced & landscaped front & back



[www.ColdwellBankerTeam.com](http://www.ColdwellBankerTeam.com)



Vonna Madeley  
360.561.7888

Leslie Shipe  
360.870.2530

Jeanne Tranum  
360.481.2255



7/20/18



Builder reserves the right to change features, plans, prices and specifications without notice. Features vary by home. Buyer to verify square footage. Homes in the Kirsop Crossing Neighborhood are built, sold, and warranted by Evergreen Heights, LLC, a separate entity that is a member of the Rob Rice Homes family of companies.