



# STEILACOOM RIDGE

## THE POPLAR

- 2,692± square feet
- 5 bedrooms, 2.5 baths
- 2-story plan
- Hardwood entry, kitchen and dining
- Slab granite or quartz kitchen counters with full tile backsplash
- 5-piece master bath
- 10 x 12 patio (as allowed by permitting)
- Fully landscaped with backyard fencing

REPRESENTED BY



[www.robricehomes.com](http://www.robricehomes.com)  
[www.facebook.com/robricehomes](http://www.facebook.com/robricehomes)



ELEVATION A



ELEVATION B

## FLOOR PLAN #2692

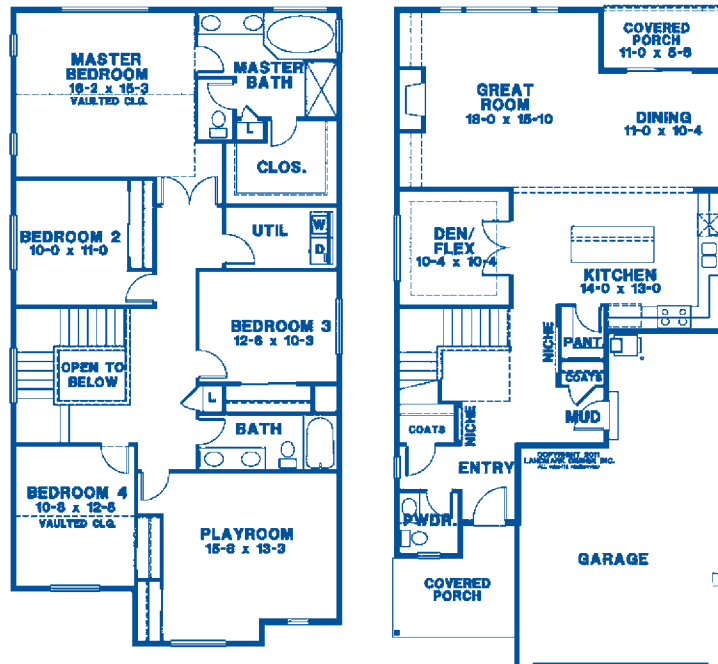

**CHRISTINA JANIS**

360.888.2295  
[christina@robricehomes.com](mailto:christina@robricehomes.com)



**LUCIA ARROYO**

360.489.7478  
[lucia@robricehomes.com](mailto:lucia@robricehomes.com)

