



Creating Exceptional Communities Since 1985

STEILACOOM RIDGE

THE HAZEL

- 2,611± square feet
- 5 bedrooms, 3.5 baths
- Main floor junior suite with full bath
- Hardwood entry, kitchen and dining
- Slab granite or quartz kitchen counters with full tile backsplash
- 5-piece master suite with French doors
- Covered porch, front and back
- Fully landscaped with backyard fencing

REPRESENTED BY



www.robricehomes.com

www.facebook.com/robricehomes



ELEVATION A



ELEVATION B

FLOOR PLAN #2611

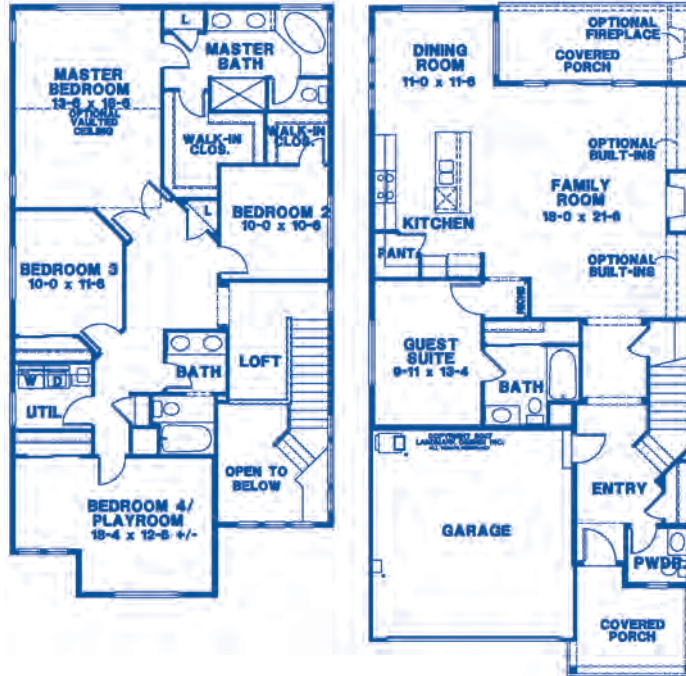

CHRISTINA JANIS

360.888.2295

christina@robricehomes.com



LUCIA ARROYO

360.489.7478

lucia@robricehomes.com



Homes in the Steilacoom Ridge community are built, sold, and warranted by Summit Land Development LLC, a separate entity that is a member of the Rob Rice Homes family of companies. Buyer to verify square footage. Features vary by plan. Builder reserves the right to make changes to plan, specifications and features without notice. 1868 State Avenue NE, Olympia, WA 98506 6/2020

